

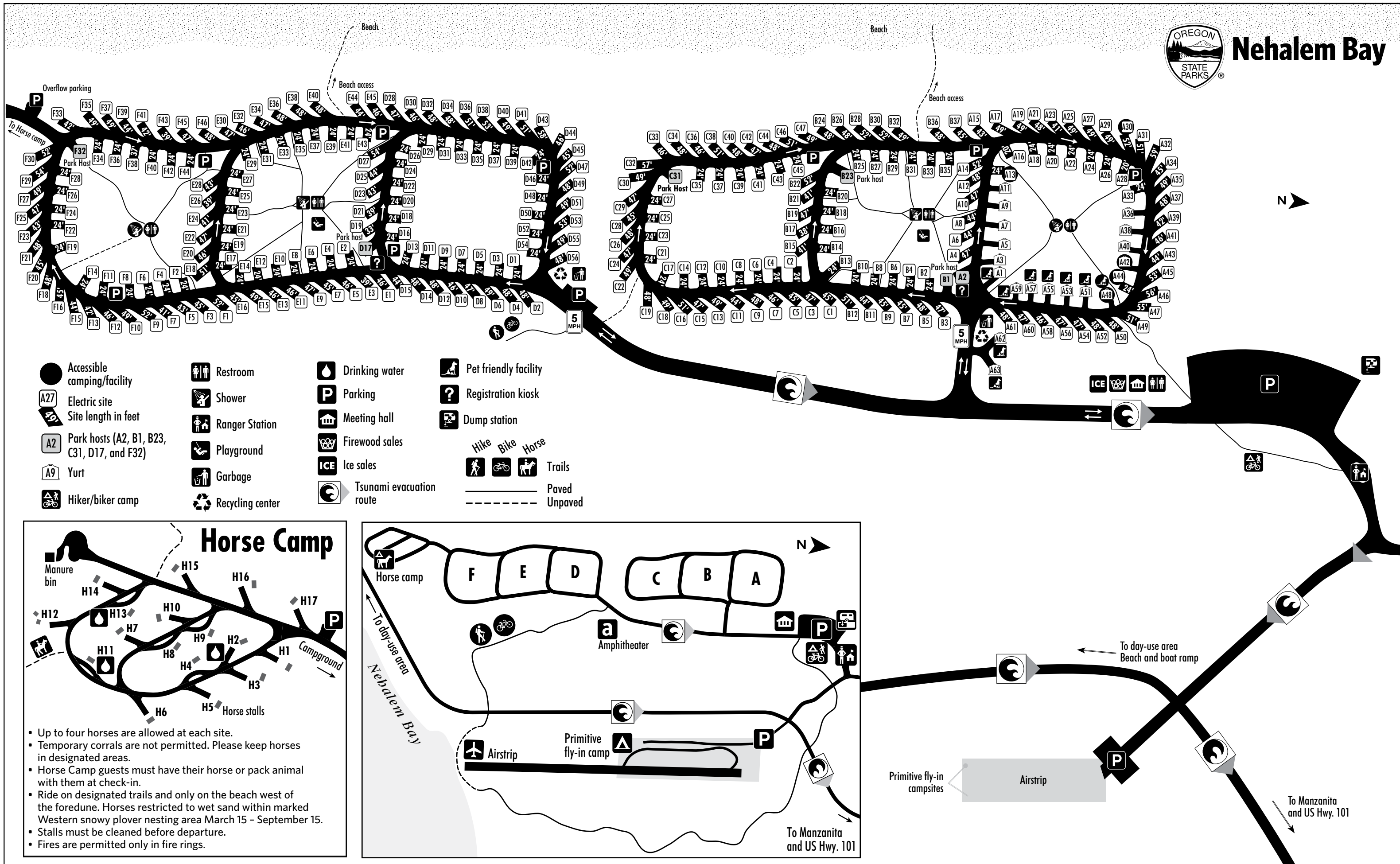

Nehalem Bay



- Accessible camping/facility
- A27 Electric site
- 49' Site length in feet
- A2 Park hosts (A2, B1, B23, C31, D17, and F32)
- A9 Yurt
- Hiker/biker camp
- Restroom
- Shower
- Ranger Station
- Playground
- Garbage
- Recycling center
- Drinking water
- P Parking
- Meeting hall
- Firewood sales
- ICE Ice sales
- Tsunami evacuation route
- Pet friendly facility
- Registration kiosk
- Dump station
- Hike Bike Horse Trails
- Paved Unpaved

Horse Camp

- Up to four horses are allowed at each site.
- Temporary corrals are not permitted. Please keep horses in designated areas.
- Horse Camp guests must have their horse or pack animal with them at check-in.
- Ride on designated trails and only on the beach west of the foredune. Horses restricted to wet sand within marked Western snowy plover nesting area March 15 – September 15.
- Stalls must be cleaned before departure.
- Fires are permitted only in fire rings.

Day-use area features include an amphitheater, primitive fly-in camp, and an airstrip. The map shows the layout of these facilities and their proximity to the beach and parking areas.



Nehalem Bay Campground Guidelines

PLEASE NOTE: Thefts can occur night or day. Secure your vehicle and your gear, coolers and gas cans.

Vehicles

All vehicles must be parked on pavement. You may park a second vehicle at your site for an extra vehicle fee, but any other vehicles must be registered and parked in overflow parking areas near the meeting hall, amphitheater, and horse camp entrance or next to sites A33, B22, D16, D42, F8, and F44.

RV Dump Station

The RV dump station is located just past the registration booth.

Quiet Hours

Quiet hours are 10 p.m. – 7 a.m., and are strictly enforced.

Recycling and Garbage

Recycling and garbage areas are near each campground loop entrance. See posted signs for items accepted for recycling.

Pets

Pets must be on leash when not confined in a vehicle or tent. Leashes may be no longer than six feet. Waste must be properly removed.

Food

Please make sure your food is stowed in a secure container. Raccoons, squirrels, and crows can tear through food and garbage bags. Raccoons are crafty and can open coolers. Feeding wildlife is prohibited for your safety and the animals' well-being.

Firewood and Campfires

You may purchase firewood at the park or bring your own. Fires are allowed only in designated fire pits within the campground and day-use areas. Burning beach driftwood in the campground or day-use areas is prohibited. Please do not leave fires unattended.

Building fires on the beach is OK, but be safe: fires must be at least 25 feet from vegetation and no larger than 3 square feet. Do not leave fires unattended and use water to extinguish them.

Bicycles

Bicycles are permitted on the bike path and on park roads, but must be ridden with the traffic flow. Bicycles are not allowed on restroom paths. Riders younger than 16 must wear helmets, which can be purchased at the park.

Shorebird Restrictions

Western snowy plovers nest along some parts of the Oregon coast, including Nehalem Bay. The tiny shorebirds are a threatened species under federal law. Watch for special signs during their nesting season, March 15 – Sept. 15. Certain recreation activities may be restricted or prohibited.

CHECK IN after 4 p.m., **CHECK OUT** by 1 p.m.
Day-use areas close at 10 p.m.

